

Scara 1:1

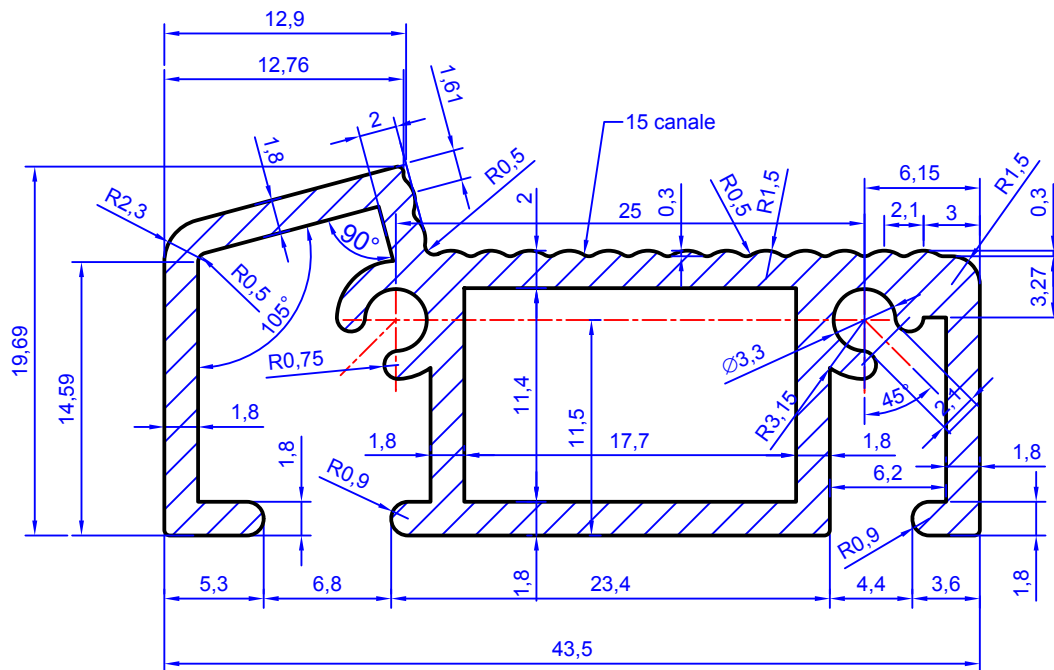

Razele de racordare necotate R=0,3

DATA	15.03.2012	ARIA (mm ²)	250,72	Tolerante SR EN 12020-2	Scara 2,5:1
PROIECTAT	ing. Eugen Popescu	PERIMETRU (mm)	265,61	Material EN AW 6060-T6 SR EN 573-3	
APROBAT	Erhan Akbulut	MASA (g/m)	680		

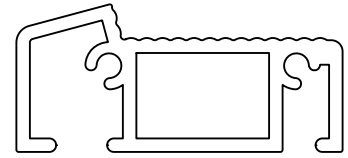

**ALUMINIUM
TECHNOLOGY**

tehnologie in aluminiu

Prag

G-545